



127 Aries Way ELERMORE VALE NSW

3 **2** **2**

PERFECT FOR THE HOME HANDYMAN OR TRADESPERSON!

Take advantage of elevated position and relaxed environs of this sturdy 80's brick and tile home in a family friendly neighbourhood. Internal access from a large double garage with storage underneath.

Downstairs entry into a spacious rumpus, fantastic billiard or games room or offers the option of a home office, study or the possibility of a 4th bedroom.

Upstairs features formal living with combustion fire. Sliding door opens to balcony, with valley views.

Type : House
Land Size : 1285 sqm
View : <https://www.dowlingproperty.com.au/sale/newcastle-region/elermore-vale/residential/house/7421781>

[For full version visit the website](https://www.dowlingproperty.com.au)

<https://www.dowlingproperty.com.au>

WM 890W
REF 890W

ACCESS UNDER
HOUSE

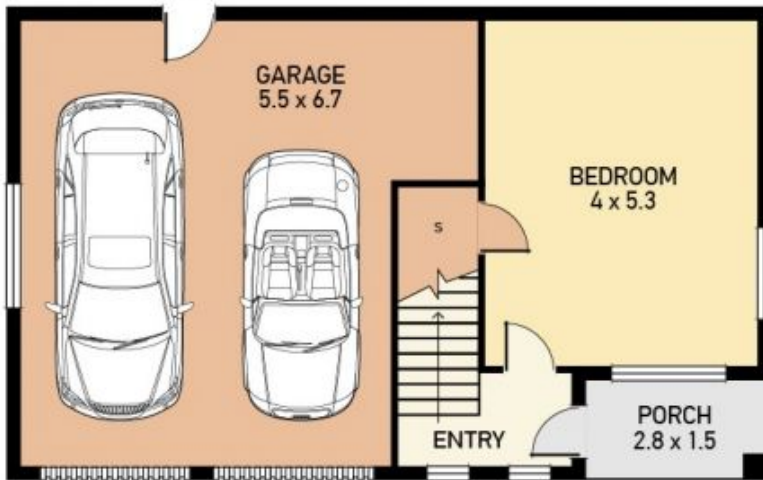

LOWER LEVEL



UPPER LEVEL

SITE PLAN
(not to scale)

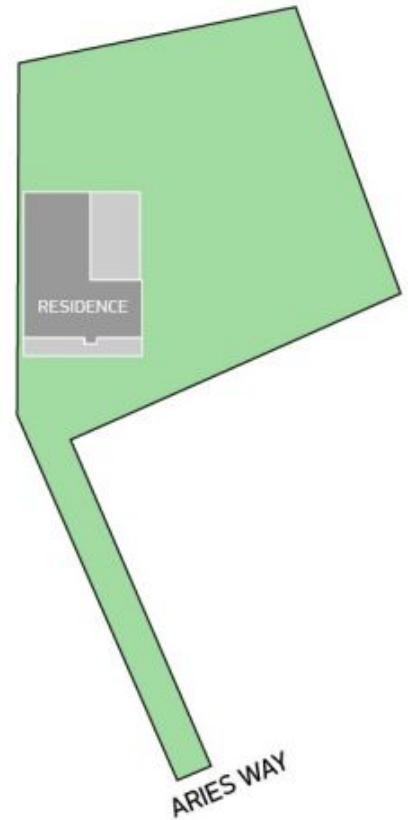

127 ARIES WAY, ELMORE VALE

Disclaimer: This information has been provided to us from the vendor and/or their conveyancer or solicitor, no guarantee is given in respect of its accuracy. Any person viewing this information should make their own enquiries and only rely on those enquiries.
© 2018 Floor Plan National - All rights Reserved

DOWLING
PROPERTY