



2/11 Kalinda Close LAMBTON NSW

3 1 1

Modern 3 bedroom townhouse in a very quiet street, in a small boutique complex, close to walking trails and minutes to Lambton village shops and Stockland Mall Jesmond.

Modern gas kitchen with dishwasher, under bench oven, shelf for microwave and plenty of cupboards

Ultra modern 3 way bathroom with frameless glass shower and separate w.c.

Open plan a/c living/dining with ceiling fans and timber look floors.

The master bedroom is downstairs with a built-in robe.

[For full version visit the website](https://www.dowlingproperty.com.au/sale/nsw/newcastle-region/lambton/residential/villa/7421803)

Type : Villa

View : <https://www.dowlingproperty.com.au/sale/nsw/newcastle-region/lambton/residential/villa/7421803>

WM 710W
REF 800W x 1770H

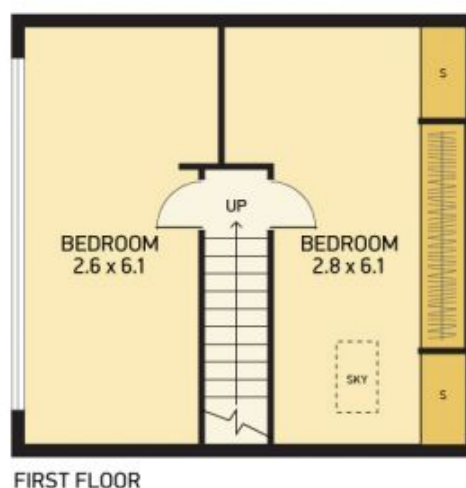

2/11 KALINDA CLOSE, LAMBTON

Disclaimer: This information has been provided to us from the vendor and or their conveyancer or solicitor, no guarantee is given in respect of its accuracy. Any person viewing this information should make their own enquiries and only rely on those enquiries.
© 2019 Floor Plan National - All rights Reserved

DOWLING
PROPERTY